

飛達部分

FEEDER UNIT

1. 高品質飛達，4吸盤吸紙，4吸盤送紙，確保穩定快速送紙。預堆紙裝置，飛達不停機，最大堆紙高度1600mm/預堆紙裝置配置軌道使操作人員可準確方便地將紙堆送入飛達。
2. 真空氣泵為德國Becker。
3. 側規可在推拉規間調節以滿足不同紙張需要。
4. 側、前規帶光電對位，可調節靈敏度。
5. 防障礙物進入設備可避免機器損壞/送紙至前規時會減速以使紙張準確定位/日本NITTA傳送帶，速度可調節/傳送板使用德國花紋不銹鋼使紙張順滑快速地傳送。
6. LED操作面板使送紙過程控制更為便捷。

1. High quality feeder made in with 4 suckers for lifting paper and 4 for forwarding paper to ensure stable and fast paper feeding. Preload device, non-stop feeding, with max pile height up to 1600mm. The preload device is equipped with guiding rails that enable the operators to move the prepared pile to feeder accurately and conveniently.
2. Vacuum pump - German Becker.
3. Side lays can be adjusted between push and pull lays to meet different kinds of paper.
4. Side and front lays are with precise photocells whose sensitivity is adjustable.
5. The anti-obstacle device is adopted to prevent the machine from damage. Paper feeding will be slow down when the paper is about to reach front lays to achieve more accurate paper position. Japanese NITTA convey belt and its speed is adjustable. German made stainless steel is used for convey board to achieve smooth and quick paper transportation.
6. Operation panel with LED display is easier to control the feeding process.

燙金部分

FOIL STAMPING UNIT

1. 縱向全幅面送箔系統，可縱向橫向同時燙金，減少用箔量并節省換箔時間。
2. 鉛制縱軸可根據客戶需要增至6軸，由獨立伺服控制/日本安川Yaskawa伺服系統/毛刷滾輪用以清除舊箔，用戶友好型的金箔架可從機內拉出方便金箔更換/最大金箔直徑：250mm。
3. 鉛制橫軸可根據客戶需要增至2軸，由獨立伺服控制。日本安川Yaskawa伺服系統。
4. 20個單獨控制加熱區，溫度±1℃，可傳熱至多個小面積區域，更加合理，及環境友好/球墨鑄鐵蜂巢版，可達到最小熱變形。
5. 縱橫雙向配有金箔分離吹氣裝置適用於大面積燙金。
6. 人機互動觸摸功能可設置不同的長拉與短拉/如金箔長度短于6m將觸發警報/計算機處理金箔監控系統顯示剩餘及已用金箔長度。
7. 選配：斷箔探測器
8. 選配：6滾筒金箔回卷裝置 型號：WFR-280。
9. 伺服馬達自動控制壓力。

1. The longitudinal full format foil feeding system make it possible to stamp the foils in longitudinal and transversal direction at the same time which helps greatly in saving waste foils as well as the time to change foil.
2. The longitudinal shaft is made of Aluminum and can be set up to 6 shafts with independent servo control depending on customer's demand. The servo system is from Japan Yaskawa. Brush roller is applied for waste foil. Foil holder can be pulled out from machine as user-friendly design to change new foil. Max. foil diameter: 250mm.
3. The transversal shaft is made of Aluminum and can be set up to 2 shafts with independent servo control depending on customer's demand. The servo system is from Japan, Yaskawa.
4. 20 individually controlled heating zone with tolerance ±1 can distribute heat into multiple small area that is more reasonable and eco-friendly. The honeycomb board is made of ductile iron with less thermal deformation.
5. The longitudinal and transversal 2-directional air blowing foil separation device is used for big area stamping.
6. Man-machine interface with touch function can be used to set up different short and long pulls. Alarm will be activated when the foil length is less than 6 m. Computerized foil monitoring system indicates used and residual foil length.
7. Optional: Foil break detector.
8. Optional: 6 rollers foil rewinding unit Model: WFR-280.
9. Servo motor to control pressure automatically.

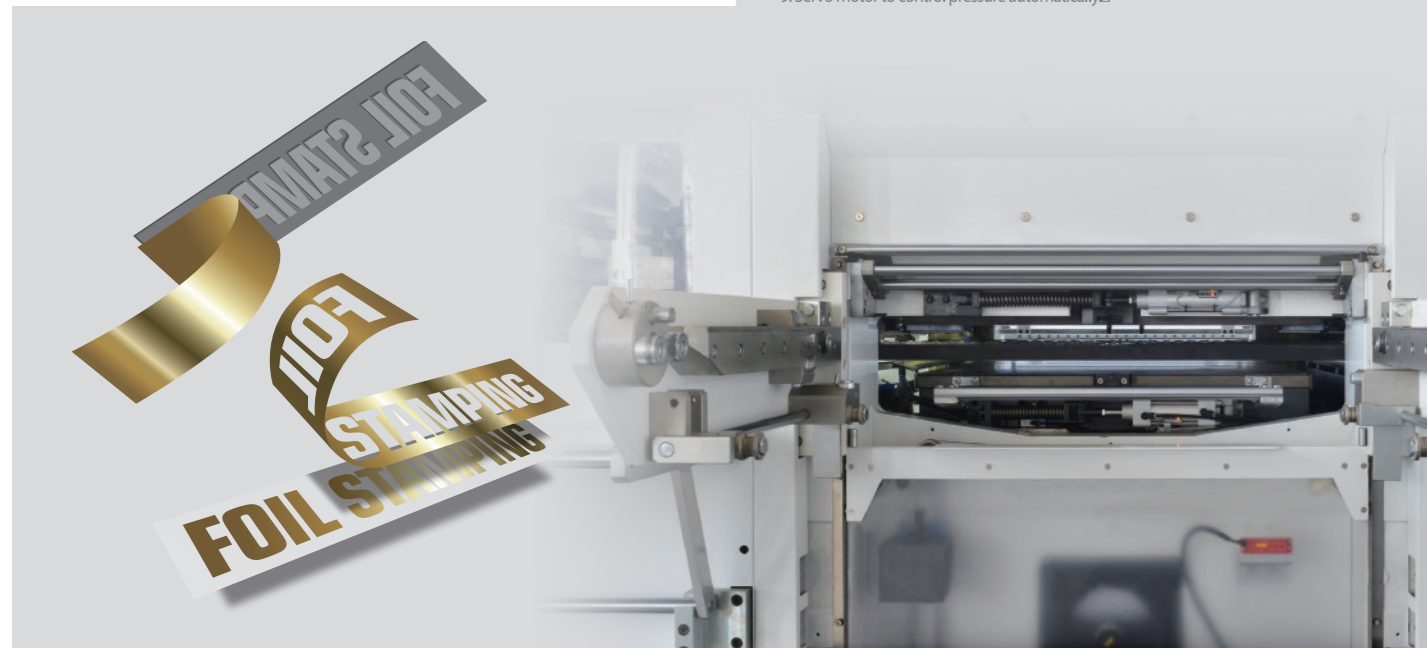

中國·國望集團
國望科技(浙江)有限公司
CHINA·GUOWANG GROUP
GUOWANG TECHNOLOGY (ZHEJIANG) CO., LTD

浙江省平阳县万全轻工机械园区
Wanquan Light Industry Machinery Park,
Pingyang Country, Zhejiang Province
T +86-577-58111111 F +86-577-58111077
E master@guowang.com

WWW.GUOWANG.COM

SHANGHAI EUREKA
MACHINERY IMP.& EXP.CO.,LTD

Room 17011727 Fourune Times Manison No.1438
Shanxi Rd(n) Shanghai P.r.china
T +86-21-62998061 62986517 62999507 F +86-21-62985160
E Info@eureka-machinery.com

WWW.EUREKA-MACHINERY.COM



中國·國望集團
CHINA·GUOWANG GROUP

KEEP IMPROVING TO WIN MORE EXPECTATION

不斷超越，才能贏得更多期待

PURSuing GERMAN AND JAPANESE QUALITY TO SHAPE A NATIONAL BRAND.
追求德日品質 塑造民族品牌

中國·國望集團始創于1993年，是一家集研發、設計、生產、銷售、服務為一體的中國印後設備專業製造商。經30多年發展積累，現有占地面積近12萬平方，建築面積超20萬平方的現代化標準工廠，并在全球設有銷售、售後服務網點。準時為客戶提供優質快捷的售前售後服務。

不斷超越，才能贏得更多期待。公司按照國際頂尖企業的標準及架構，執行7S現場管理模式。公司引進50多臺國際先進的大型加工中心，有日本三菱、東芝、馬扎克、大隈、瑞士斯達拉格、意大利帕瑪、曼德利等高精度加工設備，同時引進瑞士海克斯康三坐標檢測儀，祇因對產品精度和品質的執着追求，強大的加工集群是您設備品質的堅定保證。

國望集團通過ISO9001質量管理體系認證，主要產品均已通過歐盟CE以及德國TUV認證，匯集全球優勢資源，融合國際前沿技術，精益求精全力打造新一代印後設備，以智能化、高精度、高效率、高品質的要求，重新定義印後裝備價值，賦予用戶強大的市場競爭力，為客戶創造最大利益。

國望產品包括：全自動燙金機、模切機、卷筒分切機、切紙機、取紙機、卸紙機、升降機、開紙機等高精度印後設備。
Guowang's products include high-quality post-printing equipment such as fully Automatic hot stamping machines, Die-cutting machines, Roll slitters, Paper cutters, Paper loader, Paper unloader, Lifting machine, and jogger.

The Guowang Group, founded in 1993, is a professional manufacturer of post-press equipment in China that integrates research and development, design, production, sales, and services. After more than 30 years of development, it now has a modern standard factory with an area of nearly 120,000 square meters and a construction area of over 200,000 square meters. And has sales and after-sales service outlets worldwide, providing customers with high-quality and efficient pre-sales and after-sales services on time.

Only by constantly surpassing to win more expectations. The company implements the 7S on-site management mode according to the standards and framework of top international companies. It has introduced more than 50 international advanced large-scale machining centers, including high-precision machining equipment such as Mitsubishi, Toshiba, Mazak, Okuma, Staubli, PAMA, and Mandelli from Japan, Switzerland, and Italy. At the same time, the company has introduced the Swiss Hexagon three-coordinate measuring instrument. With its persistent pursuit of product precision and quality, the strong machining cluster is a firm guarantee for your equipment quality.

The Guowang Group has obtained ISO9001 quality management system certification, and its main products have passed the EU CE and German TUV certification. The company gathers global advantageous resources, integrates international cutting-edge technology, and strives to create a new generation of post-press equipment with intelligent, high-precision, high-efficiency, and high-quality requirements. It redefines the value of post-press equipment and gives users strong market competitiveness, creating maximum benefits for customers.



HOT STAMPING MACHINE
自动烫金&模切-E 系列

E 105 Y

Automatic hot stamping machine

自動燙金、模切機

燙金實則是印刷藝術中對美的追求。它是關注極致細節的質量突出。當您期望獲得最高的燙金質量與效果時，我們的燙金設備是您當之無愧的首選。它最多可裝配六縱、六息（防碼）、二模，可供您根據產品的需求進行任意選擇。操控系統配有19、15、10.4寸LED三屏兼容觸摸屏控制系統，在觸摸屏導航設置功能中可對紙張印刷圖案 的套準進行任意精確調整。在勻步式和跳步式的燙印過程中，電化箔箔的間距可最小調至1mm，從而使您有效的節約成本和提高效率。機械部位經過德國專業博士和日本頂級工程師的重新設計，使燙印運轉過程中可達到350噸的壓力，使得燙印、凹凸呈現出更加立體的效果，同時也保證更高的燙印速度。

Foil-stamping is actually the pursuit of beauty in the graphic arts and it focus more on the quality in details. Our machine would be your good choice if you prefer high foil-stamping quality. Can be installed with at most 6 foil feeding units in longitudinal way, 2 in transversal way and 6 for hologram for your options for different jobs. 19 inch LED touch screen from with you can adjust the registration of the printed image on the sheets precisely. The distance between the foils can be adjusted to Min.1mm in the way of step ping or skipping foil-stamping that help you to save cost and be efficient. The mechanical units are re-designed by the specialists from Germany and Japan that enable the working pressure to reach 350 tons for a better quality of foil-stamping and embossing with higher speed as well.

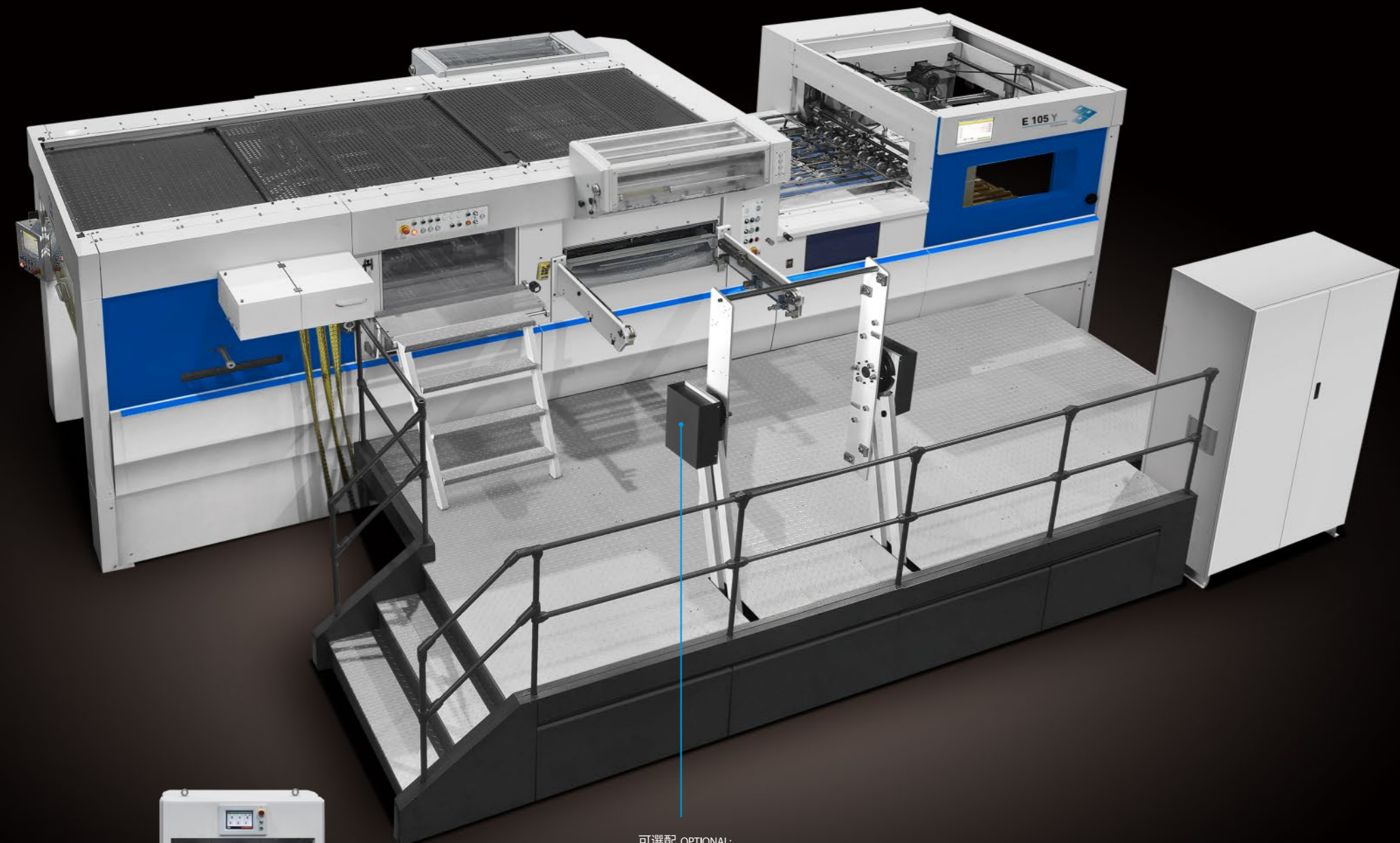

可選配 OPTIONAL:

自動收箔機WFR-280配有10.4寸LED觸摸屏自動6軸伺服收箔機
Equipped with 10.4 Inch Touch Screen Automatic 6 Axis Servo Foil Coll Ecting Machine



可選配 OPTIONAL:

氣動翻板架
Chase Changer

E 105 / E 105 Q

Automatic die-cutting machine with stripping

清廢自動模切機

該機主要用于印刷包裝工業中的紙盒、紙箱、商標的模切、壓痕和冷壓或熱壓凹凸等，特別是各種高級精細的印刷品，如煙盒、酒盒、禮品盒、小家電盒、化妝品盒等，均可以在本機上進行模切凹凸壓痕，以獲得富于立體感，精緻美觀的印刷制品。

Our machine is used for paper box, paper carton, and label die-cutting, foil stamping and embossing especially on all kinds of exquisite printing materials such as the wine box, cigarette box, gift box, and household appliance box, cosmetics box to achieve 3D and exquisite effect.

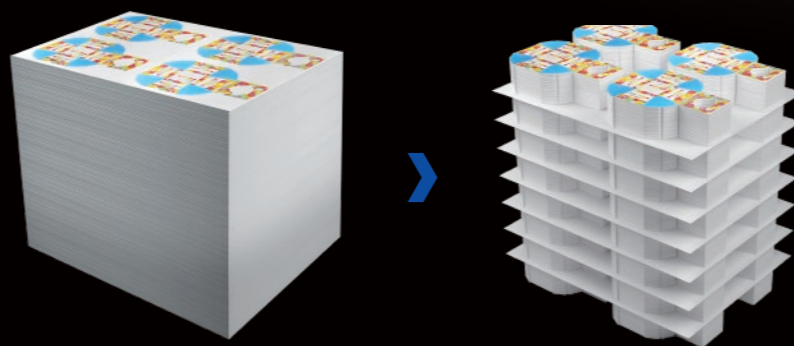
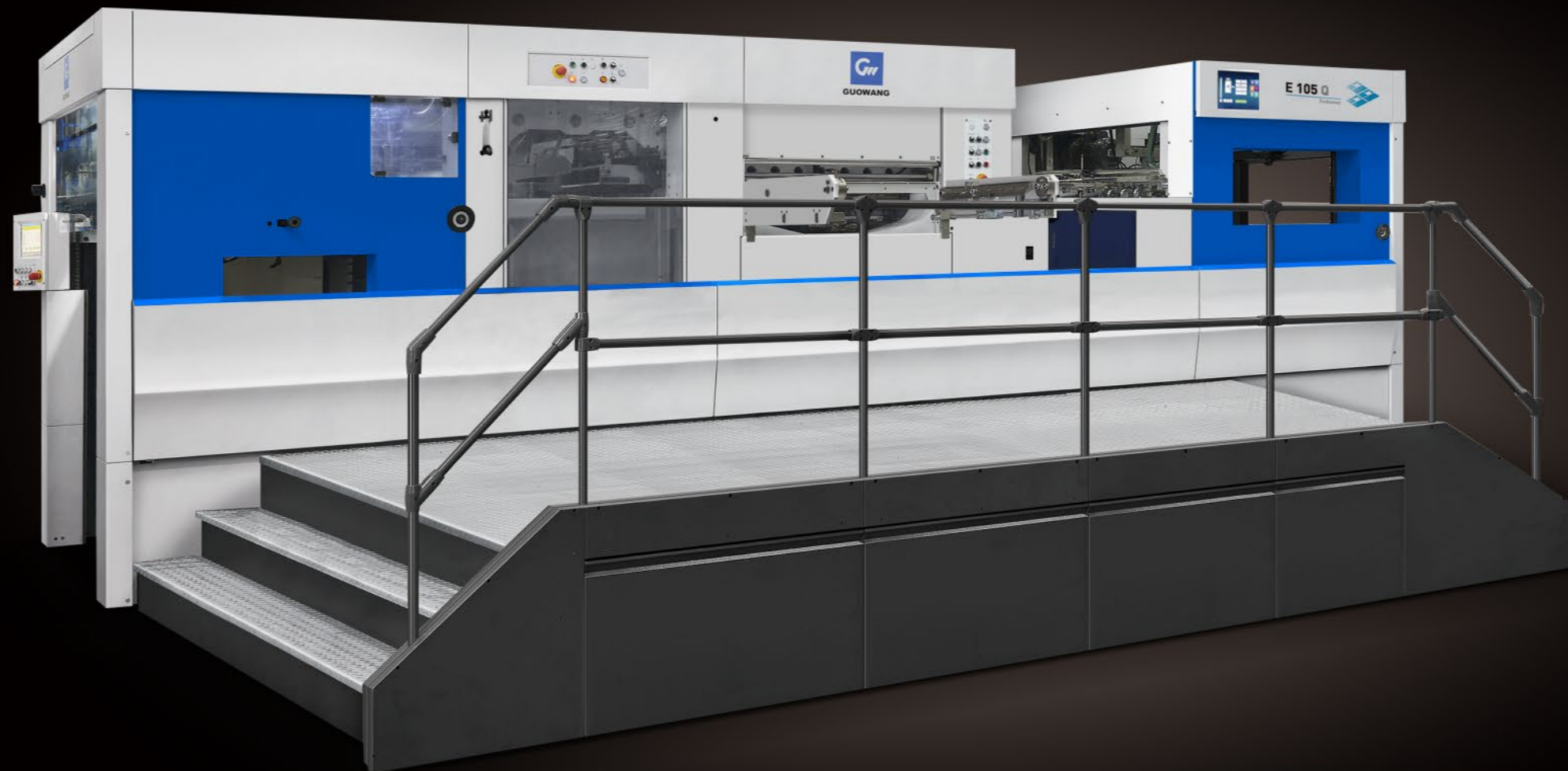

安裝地基圖 INSTALLATION FLOOR PLAN

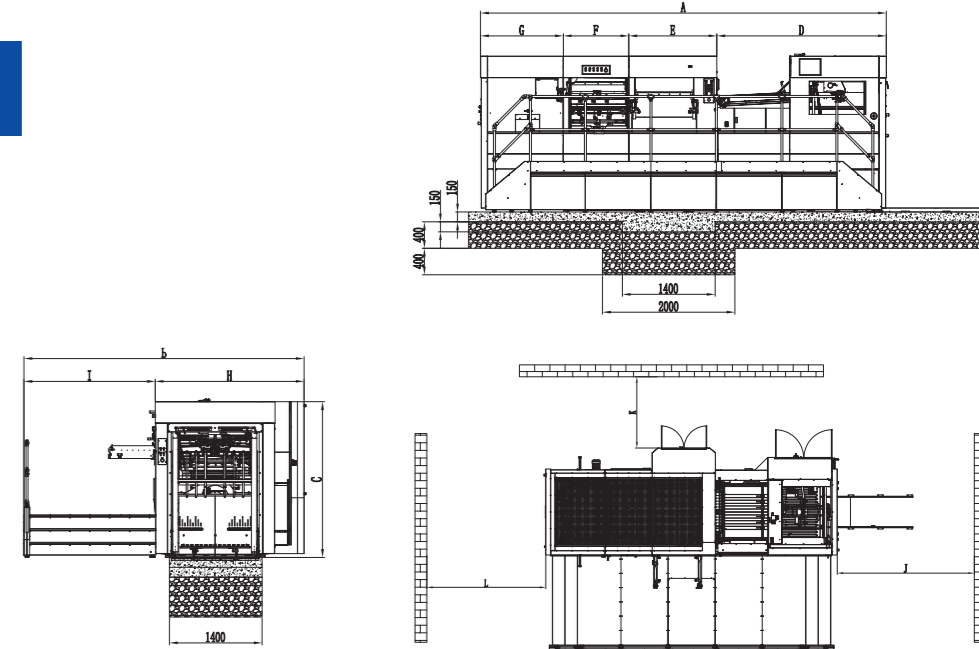

機器參數	SPECIFICATIONS	E 105	E 105 Q	E 105 V
型號	Model	E 105	E 105 Q	E 105 V
最大用紙幅面	Max. sheet size	mm 1050x760	1050x760	1050x760
最小用紙幅面	Min. sheet size	mm 360x360	450x370	450x370
最大裁切幅面	Max. die-cutting size	mm 1045x745	1045x745	1045x745
最大燙金幅面	Max. stamping size	mm /	/	1040x740
模切版框內尺寸	Die size	mm 1100x770	1100x770	1020x740
模切鋼板	Cutting plate	mm 34	34	34
鋼板的高度(模切刀)	Height of die-cutting rule	mm 23.8	23.8	23.8
刀模第一把刀機	First cutting rule	mm 13 可調(由0.5mm至13)	13 可調(由0.5mm至13)	13 可調(由0.5mm至13)
牙片咬口大小	Gripper margin	mm 9-17	9-17	9-17
白卡紙規格	Carton board	g/m² 90-2000	90-2000	90-2000
卡紙規格	Carton board	mm 0.1-3	0.1-3	0.1-3
瓦楞紙規格	Corrugated board	mm 34	34	34
最大工作壓力	Max. cutting force I	t 300	300	320
最高模切速度	Max. die-cutting speed	S/H 7500	7500	7500
最高燙金速度	Max. stamping speed	S/H /	/	6500
最大全息及鐳射燙印速度	Max. hologram speed	S/H /	/	5500
輸紙堆高度(含托盤)	Feeder pile height (incl. pallet)	mm 1600	1600	1600
收紙堆高度(含托盤)	Delivery pile height (incl. pallet)	mm 1350	1350	1350
加熱區域	Zones individually controlled	/	/	20溫區
加熱溫度	Temperature	°C /	/	20-200
最大金箔直徑	Max. Foil reel diameter	mm /	/	φ250
金箔紙芯直徑	Foil core	inch/mm /	/	25.4/76.2
主電機功率	Main motor power	kw 11	11	11
整機功率	Total power	kw 17	17	17
電壓	Voltage	V 380±5%	380±5%	380±5% 50HZ
電纜粗細	Cable	mm² 10	10	16
壓縮空氣	Compressed air	bar 6-8	6-8	6-8
用氣量	Air flow	L/Min 200	200	600

安裝數據	INSTALLATION DATA	E 105	E 105 Q	E 105 V
型號	Model	E 105	E 105 Q	E 105 V
A 機器外形總長度	Overall machine length	mm 5160	6150	6264
B 機器外形總寬度	Overall machine width	mm 4250	4250	4350
C 機器外形總高度	Overall height of machine	mm 2430	2430	2580
D 送紙機組長度	Feeder length	mm 2580	2580	2425
E 模切機組長度	Die-cutting length	mm 1330	1330	1500
F 燙金/清廢機組長度	Foil / stripping length	mm /	990	1067
G 收紙機組長度	Delivery unit length	mm 1250	1250	1270
H 機組寬度	Machine width	mm 2250	2250	2350
I 腳踏板寬度	Cat walk way width	mm 2000	2000	2000
J 送紙過道空間	Aisle for paper feeding	mm 3000	3000	3000
K 機器後過道寬	Aisle of machine side	mm 1500	1500	1500
L 出紙過道空間	Aisle for paper delivery	mm 2500	2500	2500
淨重	Net weight	t 17	18.5	20.5
包裝尺寸長	Packing size length	mm 5110	6500	6500
包裝尺寸寬	Packing size width	mm 2300	2300	2300
包裝尺寸高	Packing size height	mm 2530	2530	2530

注：由于產品在不斷的改進，數據如有改動，恕不另行通知。